

PLAN

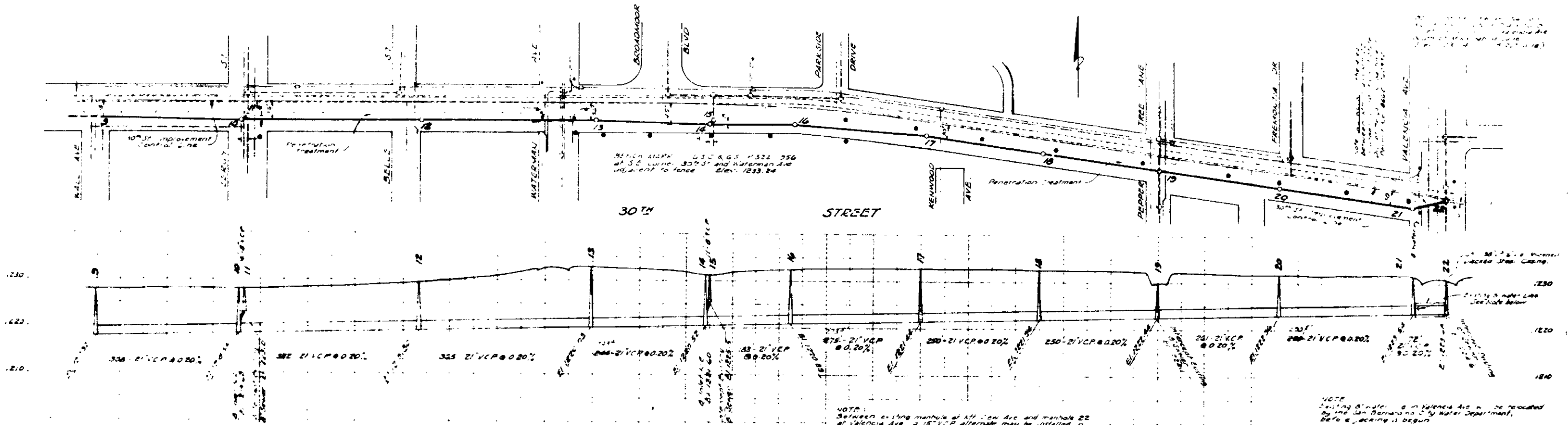

LIST OF TERMINAL MANHOLES

No.	Location	Station
1	At 1st St. - 180' N. of E. 29th St.	1+00
2	At 2nd St. - 180' N. of E. 29th St.	1+10
3	At 3rd St. - 180' N. of E. 29th St.	1+20
4	At 4th St. - 180' N. of E. 29th St.	1+30
5	At 5th St. - 180' N. of E. 29th St.	1+40
6	At 6th St. - 180' N. of E. 29th St.	1+50
7	At 7th St. - 180' N. of E. 29th St.	1+60
8	At 8th St. - 180' N. of E. 29th St.	1+70
9	At 9th St. - 180' N. of E. 29th St.	1+80
10	At 10th St. - 180' N. of E. 29th St.	1+90
11	At 11th St. - 180' N. of E. 29th St.	2+00
12	At 12th St. - 180' N. of E. 29th St.	2+10
13	At 13th St. - 180' N. of E. 29th St.	2+20
14	At 14th St. - 180' N. of E. 29th St.	2+30
15	At 15th St. - 180' N. of E. 29th St.	2+40
16	At 16th St. - 180' N. of E. 29th St.	2+50
17	At 17th St. - 180' N. of E. 29th St.	2+60
18	At 18th St. - 180' N. of E. 29th St.	2+70
19	At 19th St. - 180' N. of E. 29th St.	2+80
20	At 20th St. - 180' N. of E. 29th St.	2+90
21	At 21st St. - 180' N. of E. 29th St.	3+00
22	At 22nd St. - 180' N. of E. 29th St.	3+10
23	At 23rd St. - 180' N. of E. 29th St.	3+20
24	At 24th St. - 180' N. of E. 29th St.	3+30
25	At 25th St. - 180' N. of E. 29th St.	3+40
26	At 26th St. - 180' N. of E. 29th St.	3+50
27	At 27th St. - 180' N. of E. 29th St.	3+60
28	At 28th St. - 180' N. of E. 29th St.	3+70
29	At 29th St. - 180' N. of E. 29th St.	3+80
30	At 30th St. - 180' N. of E. 29th St.	3+90
31	At 31st St. - 180' N. of E. 29th St.	4+00
32	At 32nd St. - 180' N. of E. 29th St.	4+10

PROFILE

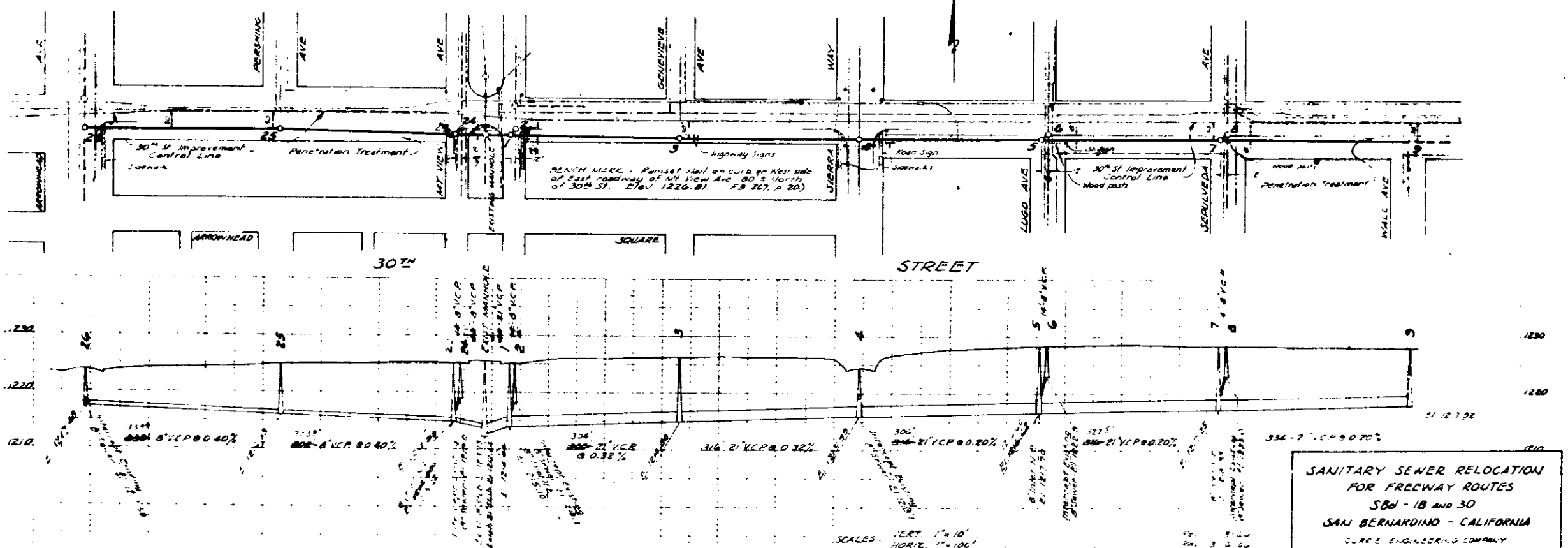

SANITARY SEWER RELOCATION FOR FREEWAY ROUTES SBd - 1B AND 30 SAN BERNARDINO - CALIFORNIA CURRIS ENGINEERING COMPANY

DATE: 02-25 P. 215 & PROFILES 2 of 3

PLAN No 333d

REVISED AS BUILT 3-10-66

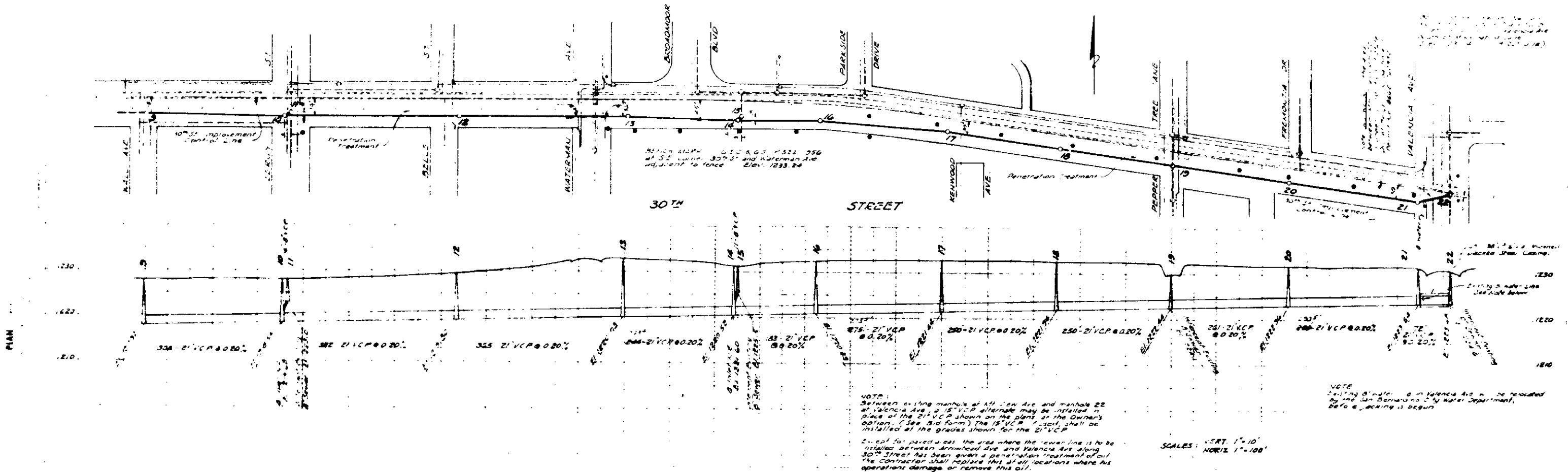

PLAN

PROFILE

LIST OF TERMINAL MANHOLES

No.	Location	Station
1	At 1st St. - 100' N. of E. 29th St.	1+00
2	At 2nd St. - 100' N. of E. 29th St.	1+50
3	At 3rd St. - 100' N. of E. 29th St.	2+00
4	At 4th St. - 100' N. of E. 29th St.	2+50
5	At 5th St. - 100' N. of E. 29th St.	3+00
6	At 6th St. - 100' N. of E. 29th St.	3+50
7	At 7th St. - 100' N. of E. 29th St.	4+00
8	At 8th St. - 100' N. of E. 29th St.	4+50
9	At 9th St. - 100' N. of E. 29th St.	5+00
10	At 10th St. - 100' N. of E. 29th St.	5+50
11	At 11th St. - 100' N. of E. 29th St.	6+00
12	At 12th St. - 100' N. of E. 29th St.	6+50
13	At 13th St. - 100' N. of E. 29th St.	7+00
14	At 14th St. - 100' N. of E. 29th St.	7+50
15	At 15th St. - 100' N. of E. 29th St.	8+00
16	At 16th St. - 100' N. of E. 29th St.	8+50
17	At 17th St. - 100' N. of E. 29th St.	9+00
18	At 18th St. - 100' N. of E. 29th St.	9+50
19	At 19th St. - 100' N. of E. 29th St.	10+00
20	At 20th St. - 100' N. of E. 29th St.	10+50
21	At 21st St. - 100' N. of E. 29th St.	11+00
22	At 22nd St. - 100' N. of E. 29th St.	11+50
23	At 23rd St. - 100' N. of E. 29th St.	12+00
24	At 24th St. - 100' N. of E. 29th St.	12+50
25	At 25th St. - 100' N. of E. 29th St.	13+00
26	At 26th St. - 100' N. of E. 29th St.	13+50
27	At 27th St. - 100' N. of E. 29th St.	14+00
28	At 28th St. - 100' N. of E. 29th St.	14+50
29	At 29th St. - 100' N. of E. 29th St.	15+00
30	At 30th St. - 100' N. of E. 29th St.	15+50
31	At 31st St. - 100' N. of E. 29th St.	16+00
32	At 32nd St. - 100' N. of E. 29th St.	16+50

NOTE: The location of the manholes is shown on the plan view. The stationing is given in feet from the beginning of the sewer line at the intersection of 30th Street and Arrowhead Avenue.

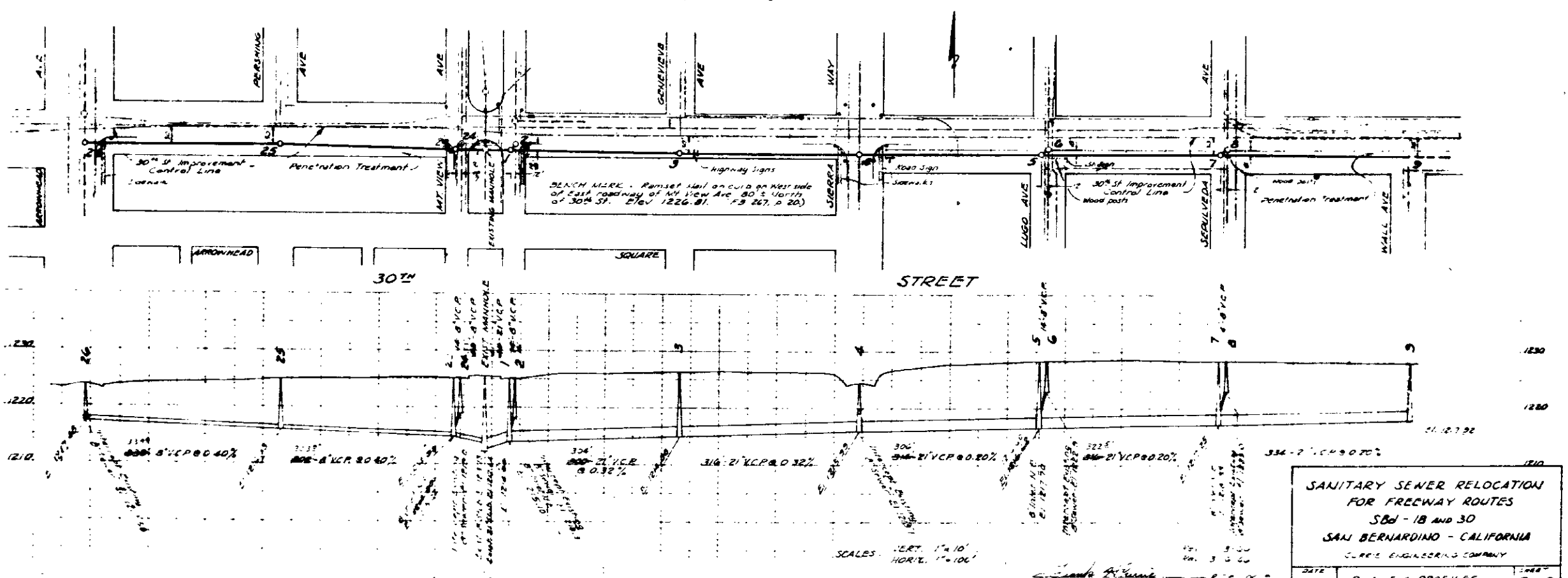

PROFILE

SANITARY SEWER RELOCATION FOR FREEWAY ROUTES SBd-1B AND 30 SAN BERNARDINO - CALIFORNIA CURRIS ENGINEERING COMPANY

DATE: 02-25-65 P. 21.5 & PROFILES 2 of 3 PLAN No 333d

REVISIONS AS BUILT 3-10-65

NOTE: Between existing manhole at Arrowhead Ave and manhole 22 at Valencia Ave, a 15" VCP alternate may be installed in place of the 21" VCP shown on the plan, at the Owner's option. (See bid form.) The 15" VCP, if used, shall be installed at the grades shown for the 21" VCP.

NOTE: The contractor shall replace this at all locations where his operations damage or remove this oil.

SCALE: VERT. 1"=10' HORIZ. 1"=100'

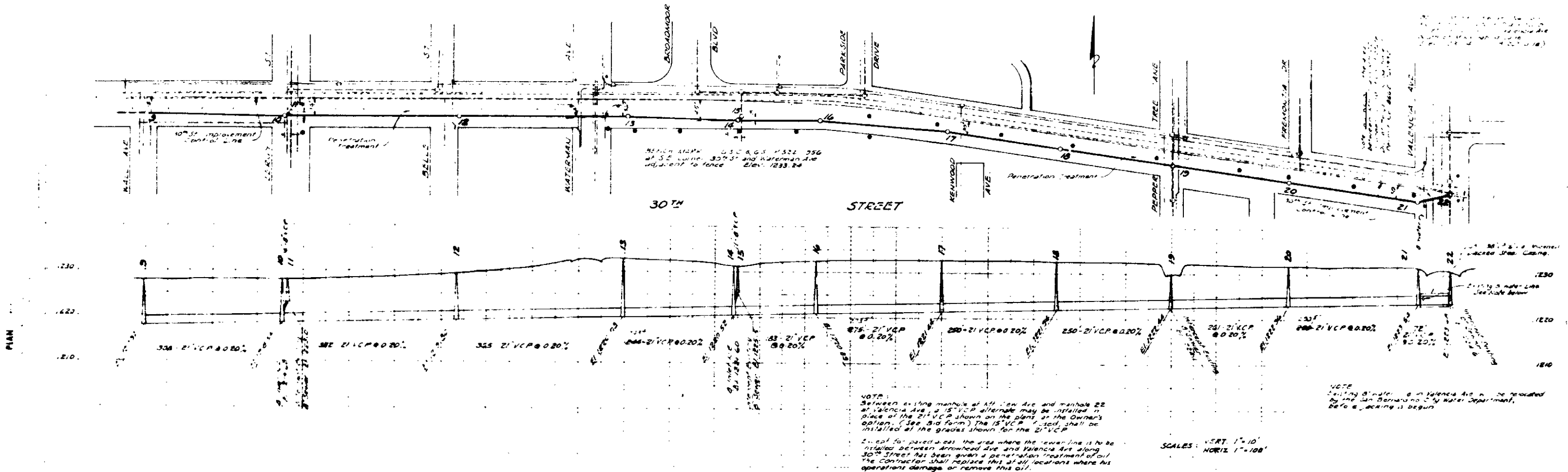

PLAN

PROFILE

LIST OF TERMINAL MANHOLES

No.	Location	Station
1	At 1st St. - 100' N. of E. 29th St.	1+00
2	At 2nd St. - 100' N. of E. 29th St.	1+50
3	At 3rd St. - 100' N. of E. 29th St.	2+00
4	At 4th St. - 100' N. of E. 29th St.	2+50
5	At 5th St. - 100' N. of E. 29th St.	3+00
6	At 6th St. - 100' N. of E. 29th St.	3+50
7	At 7th St. - 100' N. of E. 29th St.	4+00
8	At 8th St. - 100' N. of E. 29th St.	4+50
9	At 9th St. - 100' N. of E. 29th St.	5+00
10	At 10th St. - 100' N. of E. 29th St.	5+50
11	At 11th St. - 100' N. of E. 29th St.	6+00
12	At 12th St. - 100' N. of E. 29th St.	6+50
13	At 13th St. - 100' N. of E. 29th St.	7+00
14	At 14th St. - 100' N. of E. 29th St.	7+50
15	At 15th St. - 100' N. of E. 29th St.	8+00
16	At 16th St. - 100' N. of E. 29th St.	8+50
17	At 17th St. - 100' N. of E. 29th St.	9+00
18	At 18th St. - 100' N. of E. 29th St.	9+50
19	At 19th St. - 100' N. of E. 29th St.	10+00
20	At 20th St. - 100' N. of E. 29th St.	10+50
21	At 21st St. - 100' N. of E. 29th St.	11+00
22	At 22nd St. - 100' N. of E. 29th St.	11+50
23	At 23rd St. - 100' N. of E. 29th St.	12+00
24	At 24th St. - 100' N. of E. 29th St.	12+50
25	At 25th St. - 100' N. of E. 29th St.	13+00
26	At 26th St. - 100' N. of E. 29th St.	13+50
27	At 27th St. - 100' N. of E. 29th St.	14+00
28	At 28th St. - 100' N. of E. 29th St.	14+50
29	At 29th St. - 100' N. of E. 29th St.	15+00
30	At 30th St. - 100' N. of E. 29th St.	15+50
31	At 31st St. - 100' N. of E. 29th St.	16+00
32	At 32nd St. - 100' N. of E. 29th St.	16+50

NOTE: The location of the manholes is shown on the plan view. The stationing is given in feet from the beginning of the sewer line at the intersection of 30th Street and Valencia Avenue.

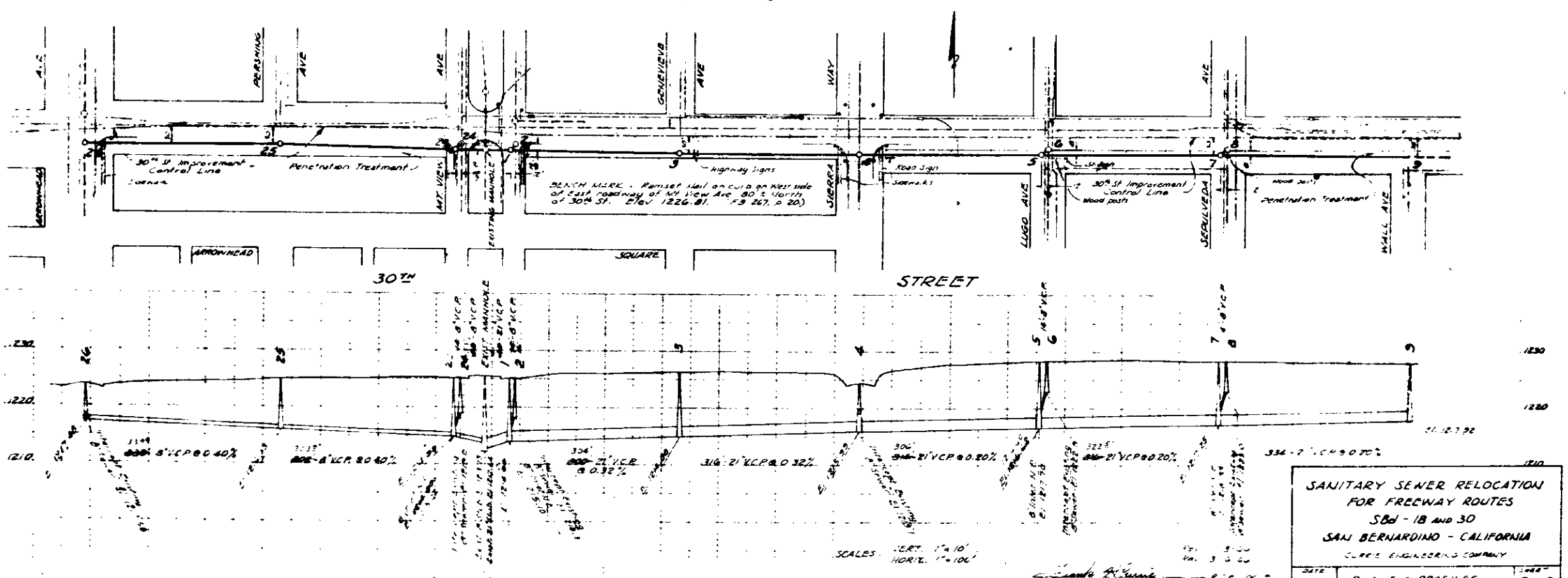

PROFILE

SANITARY SEWER RELOCATION FOR FREEWAY ROUTES SBd - 1B AND 30 SAN BERNARDINO - CALIFORNIA CURRIS ENGINEERING COMPANY

DATE: 02-25-65 P. 21.5 & PROFILES 2 of 3 PLAN No 333d

REVISIONS AS BUILT 3-10-65

NOTE: Between existing manhole at Arrowhead Ave and manhole 22 at Valencia Ave, a 15" VCP alternate may be installed in place of the 21" VCP shown on the plan, at the Owner's option. (See bid form.) The 15" VCP, if used, shall be installed at the grades shown for the 21" VCP.

NOTE: The contractor shall replace this at all locations where his operations damage or remove this oil.

SCALE: VERT. 1"=10' HORIZ. 1"=100'